

Blocking panels (if included) are not intended to be used to set truss spacing, these accessory items should be trimmed to fit on site

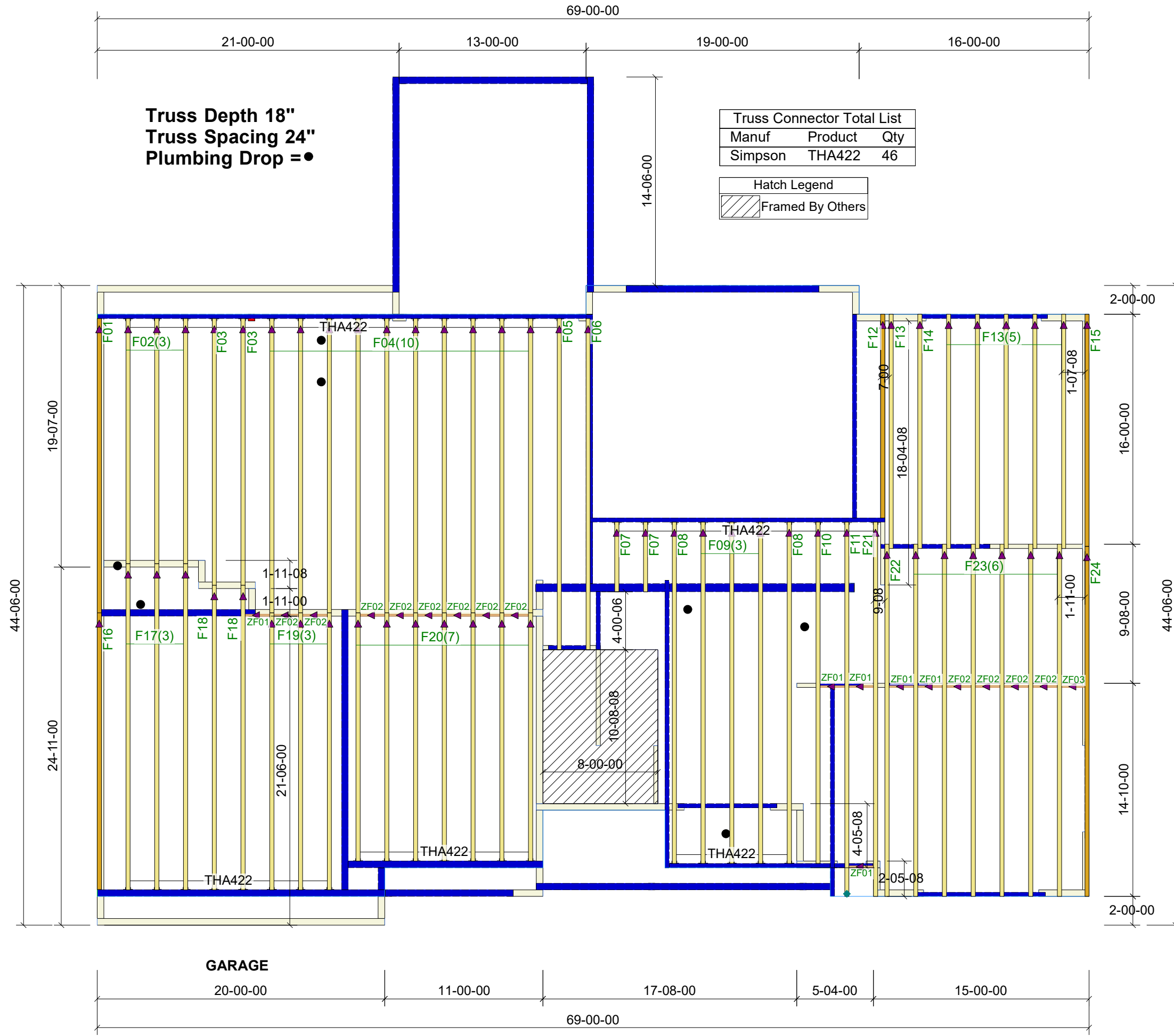

**** IMPORTANT ****

▼ = INDICATES LEFT END

Address:

- THIS IS A TRUSS PLACEMENT PLAN ONLY. All trusses are designed as individual building components built to the building designer's specifications as given to us in the plans, see individual truss design sheets for specific loading and design.
 - VERIFY ALL DIMENSIONS. Temporary truss bracing is the responsibility of the general contractor. Permanent bracing is the responsibility of the building designer. Individual bracing of "at-compression" truss pieces is marked out on the truss seals and it is the responsibility of the contractor to verify it is installed as specified.
 - Do not install broken/damaged trusses or trusses that do not match the jobsite conditions, please inform your salesman if any such conditions are discovered.
 - All Truss-To-Structural element connections shown on this layout are a suggestion provided as a courtesy to the builder and must be specified in the construction documents as approved by the building designer per ANSI/TPI 1-2014 2.3.2.4 prior to their installation.

Drawing Type:
Floor Trusses
Loading
 TC/LL= 40.0 lb/ft²
 TC/DL= 10.0 lb/ft²
 BC/LL= 0.0 lb/ft²
 BC/DL= 5.0 lb/ft²
 IRC 2021

Customer: Summer
 ACH Homes LLC
Job Name: 4024 - 85th Ave SE
 4024 85th Ave SE
Job Number: J1183948F2
 J1183948F2
Plan:

Sales Rep:
 Chad Sienkiewicz
Estimate By:
 Lam Pham
Finalized By:
 Unassigned
Date:
 6/9/2025

